

hydroo®

SDR00 SERIES

S3P

S3.5P

50Hz

**Deep-Well
Submersible
Pump 3"-3.5"**



PRODUCTS

Presentation	3
3” S3P	4
3.5” S3.5P	7
3” S3P Dimensions	10
3” S3.5P Dimensions	11

PRESENTATION

HYDROO has set up a worldwide distribution network with key partners and is providing value to pump engineers and end users. We have an extensive pump portfolio with high -end solutions for many applications, including water-supply booster sets, fire-fighting equipment, borehole, HVAC, drainage and sewage, utilities, irrigation, desalination and RO equipment, and OEM integration, among many others. We provide solutions for all markets for 50 Hz and 60 Hz, including customized versions.

HYDROO has a factory in Palol de Revardit (Catalonia- Spain). It’s been sized to guarantee our reliable, long-term, personalized manner and offer the best service to all our customers. We provide a wide range of products in an extremely short delivery time, thanks to our Lean manufacturing processes and our qualified professional and enthusiastic team.

Our commitment to ethics and legislation in relation to third parties is compiled in a public document of principles. The document has been agreed upon by the entire Hydroo team and its implementation is being co-ordinated by a committee to ensure the compliance and strengthening of the corporate culture in the whole company.

The expansion of Hydroo is based on excellence in operations and a successful business relationship with partners. Therefore, we face a strong growth in the target market. We are fully audited by SGS for ISO9001 and ISO14000 standards annually.

At HYDROO, we are committed to providing excellent service to our valued pump partners.

S3P
50Hz 3”
Submersible
Multistage
Technical Data

Applications

For water supply from wells or reservoirs.
For domestic use, for civil and industrial applications.
For garden use and irrigation.

Operating conditions

Maximum fluid temperature up to +35°C.
Maximum sand content: 0.25%.
Maximum immersion: 80m.
Minimum well diameter: 3”.

Motor and pump

- Rewindable motor
- Three-phase: 350V-400V/50Hz
- Single-phase: 180V-230V/50Hz
- Equipped with start-up control box or digital auto-control box
- Pumps are designed by casing stressed
- NEMA dimension standards
- Performance curve tolerance according to ISO 99906 annex A

Outlet diameter

1”

S3P2 - 10

S3P: Stainless steel submersible 3” borehole pump, sand resistant type, POM impeller
2: Rated flow (m³/h)
10: Number of impellers

hydroo®



Components	Material
Delivery casing	AISI 304 SS
Strainer	AISI 304 SS
Diffuser	Polycarbonate
Impeller	POM
Shaft	AISI 304 SS
Shaft coupling	AISI 304 SS
Wear ring	Rubber NBR
Motor extenal casing	AISI 304 SS
Mechanical seal	Special seal for deep well (carbor-sic/tc)
Shaft	AISI 304 SS
Bearing	NSK
Seal lubricant oil	Oil for food machinery and pharmaceutic use.

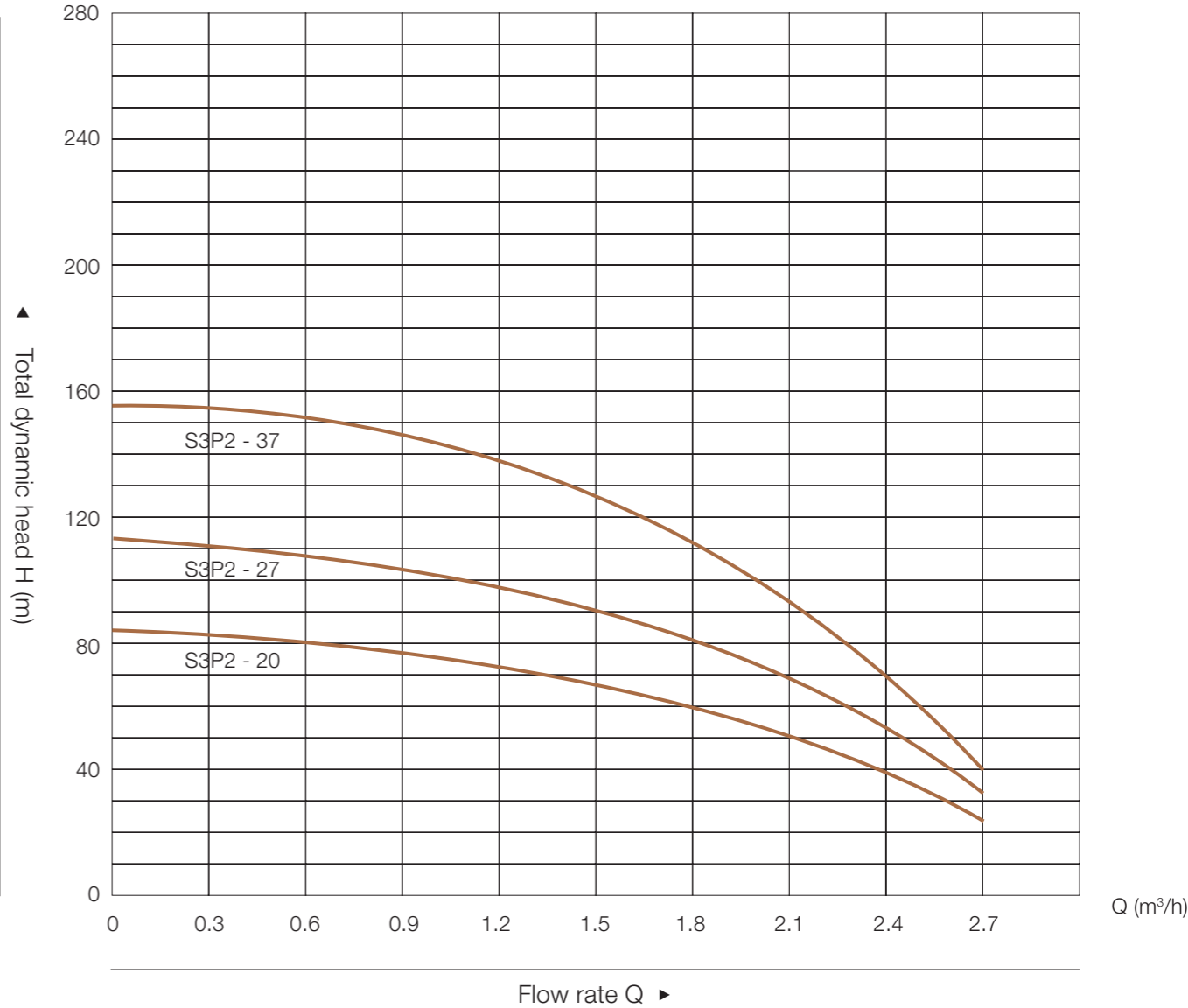

Performance table

Type	Motor power		Q(m³/h)	Delivery N~2850r/min									
	KW	H		0	0.3	0.6	0.9	1.2	1.5	1.8	2.1	2.4	2.7
S3P2-20	0.55	0.75	H(m)	84	82	78	76	72	66	58	48	36	20
S3P2-27	0.75	1		113	111	105	102	97	89	79	65	48	27
S3P2-37	1.1	1.5		155	152	144	140	133	122	107	89	66	37

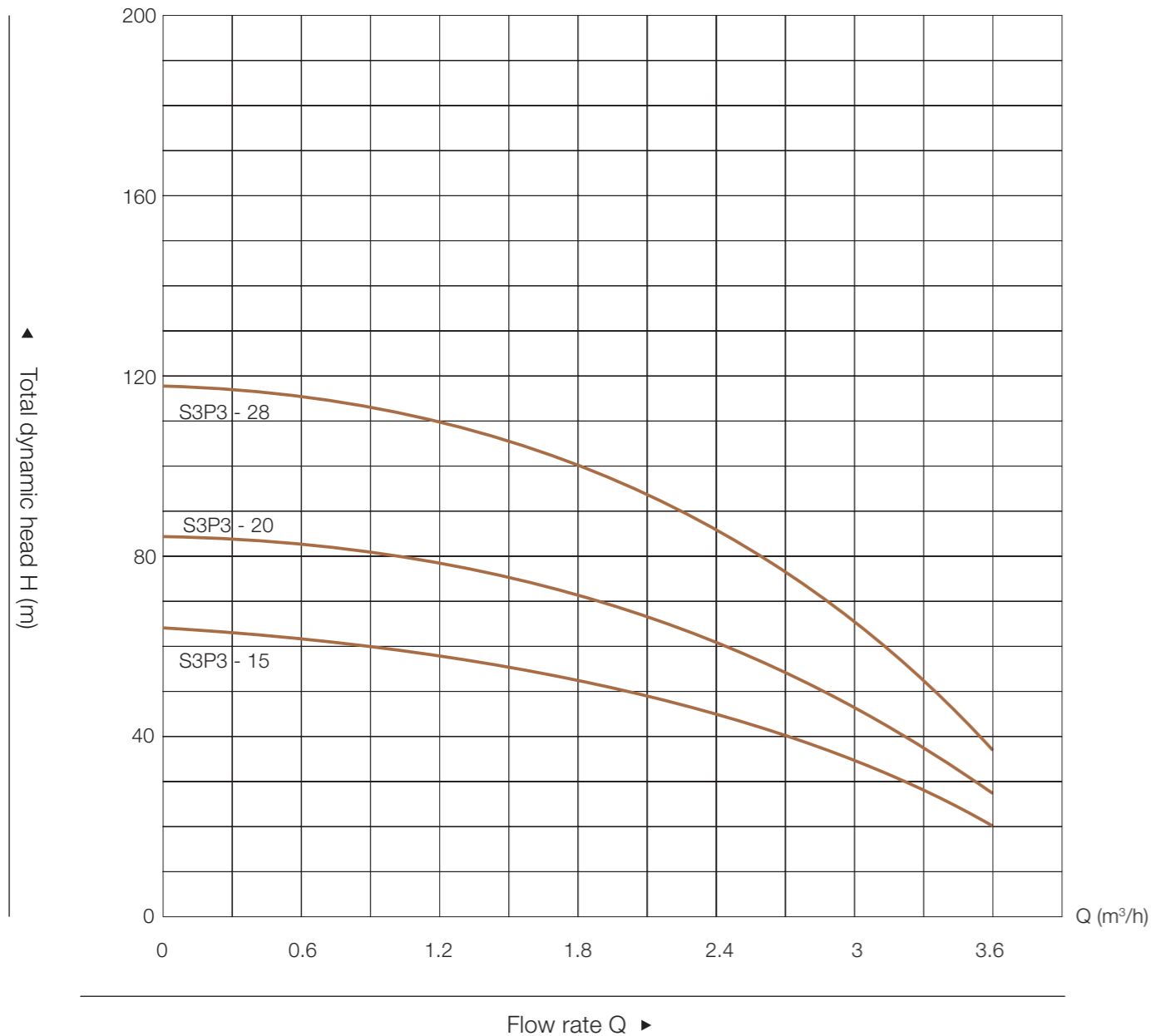

Performance table

Type	Motor power		Delivery N≈2850r/min													
Three Phase / Single Phase	KW	H	Q(m³/h)	0	0.3	0.6	0.9	1.2	1.5	1.8	2.1	2.4	2.7	3	3.3	3.6
S3P3-15	0.55	0.75	H(m)	63	62	61	60	58	56	53	50	46	41	35	27	20
S3P3-20	0.75	1		84	83	82	80	78	74	71	67	61	54	46	37	27
S3P3-28	1.1	1.5		117	116	114	112	109	104	100	93	86	76	65	51	37

S3.5P 50Hz 3.5” Submersible Multistage

Tecnical Data

Applications

For water supply from wells or reservoirs.
For domestic use, for civil and industrial applications.
For garden use and irrigation.

Operating conditions

Maximum fluid temperature up to +35°C
Maximum sand content: 3%
Maximum immersion: 120m.
Minimum well diameter: 3.5”

Motor and pump

- Rewindable motor
- Three-phase: 350V-415V/50Hz
- Single-phase: 150V-240V/50Hz
- Equipped with start-up control box

Outlet diameter

1 1/4”

S3.5P2 - 9

S3.5P: Stainless Steel submersible 3,5” borehole pump, sand-resistant type, POM impeller

2: Rated flow (m3/h)

9: Number of impeller

hydroo®



Components	Material
Pump casing	AISI 304 SS / 201 SS
Outlets	Cast-Cu
Inlets	Cast-Cu
Strainer	AISI 304 SS
Diffuser	Polycarbonate
Impeller	POM
Pump shaft	AISI 304 SS / 201 SS
Shaft coupling	AISI 304 SS / 201 SS
Motor casing	AISI 304 SS / 201 SS
Top chock	Cast-Cu / Cast-Iron
Mechanical seal	Graphite-Ceramic / TC
Motor shaft	AISI 304 SS
Bearing	NSK / C&U
Seal lubricant oil	10# White oil

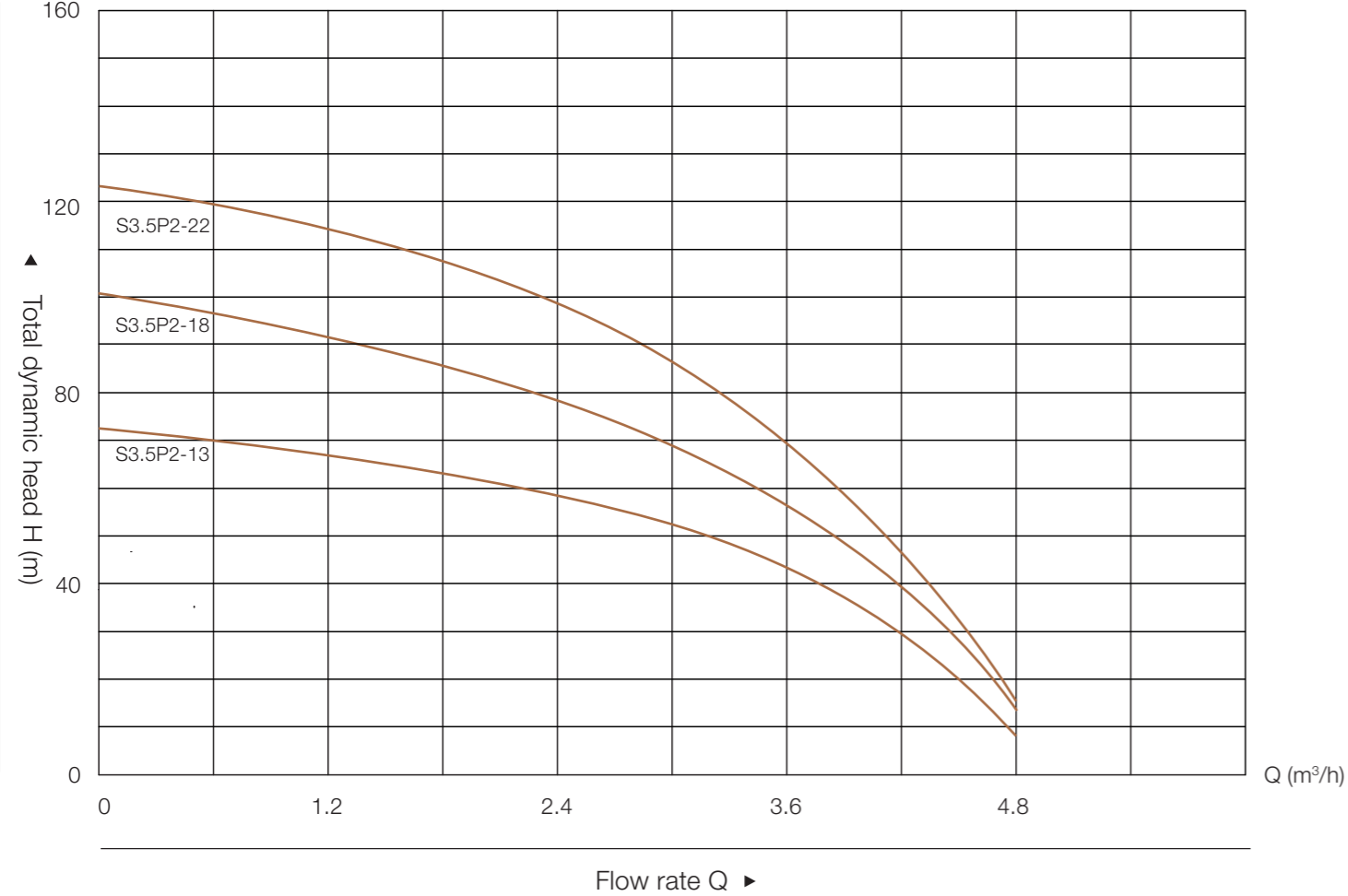

Performance table

Type	Motor power		Q(m³/h) l./min	Delivery N≈2850r/min								
				0	0.6	1.2	1.8	2.4	3.0	3.6	4.2	4.8
	KW	HP		0	10	20	30	40	50	60	70	80
S3.5P2-13	0.55	0.75	H(m)	73	70	66	64	57	52	44	29	9
S3.5P2-18	0.95	1.3		101	97	92	89	79	68	57	40	13
S3.5P2-22	1.1	1.5		123	119	112	109	97	83	70	48	15

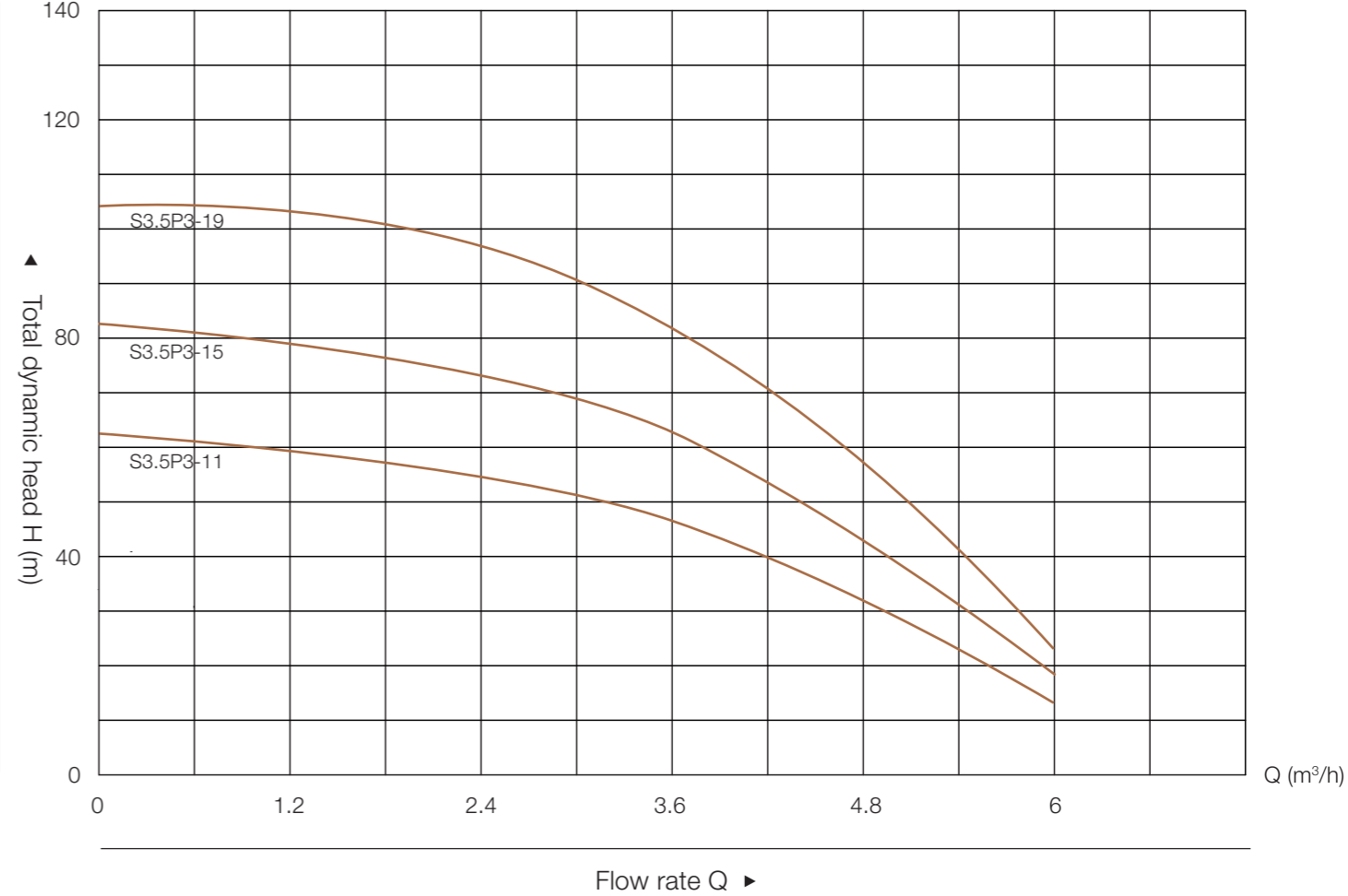

Performance table

Type	Motor power		Delivery N≈2850r/min											
Three Phase/ Single Phase	KW	HP	Q(m³/h) l./min	0	0.6	1.2	1.8	2.4	3.0	3.6	4.2	4.8	5.4	6.0
				0	10	20	30	40	50	60	70	80	90	100
S3.5P3-11	0.55	0.75	H(m)	62	61	59	58	54	50	45	40	33	22	13
S3.5P3-15	0.95	1.3		82	81	79	78	74	68	62	55	45	30	18
S3.5P3-19	1.1	1.5		103	102	100	100	93	87	78	70	57	38	23

S3P

50Hz 3"

Installation dimension

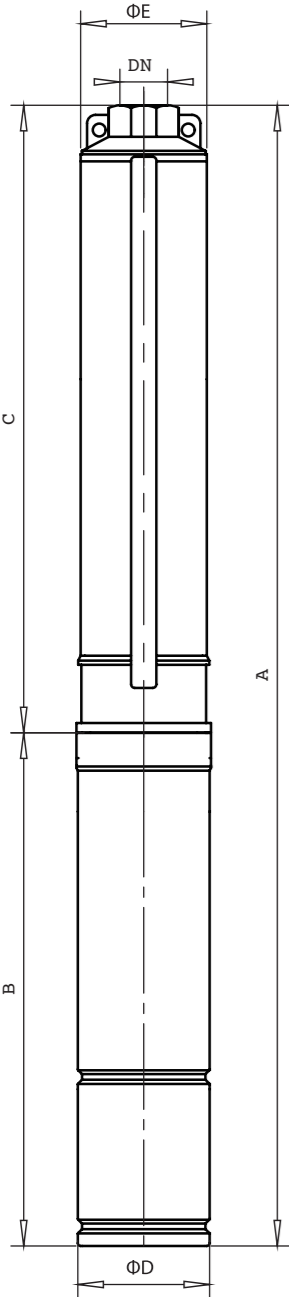

hydroo®

Model	Size (mm)						Weight (kg)	
	A	B	C	DN	ΦE	ΦD	Pump with motor	Controller
S3P2-20	1093	407	686	1"	69	72	10.3	0.75
S3P2-27	1324	458	866	1"	69	72	12.5	0.75
S3P2-37	1636	523	1113	1"	69	72	15.2	0.75

Model	Size (mm)						Weight (kg)	
	A	B	C	DN	ΦE	ΦD	Pump with motor	Controller
S3P3-15	1037	407	630	1"	69	72	10.1	0.75
S3P3-20	1219	458	761	1"	69	72	12.1	0.75
S3P3-28	1516	523	993	1"	69	72	14.7	0.75

S3.5P

50Hz 3,5"

Installation dimension

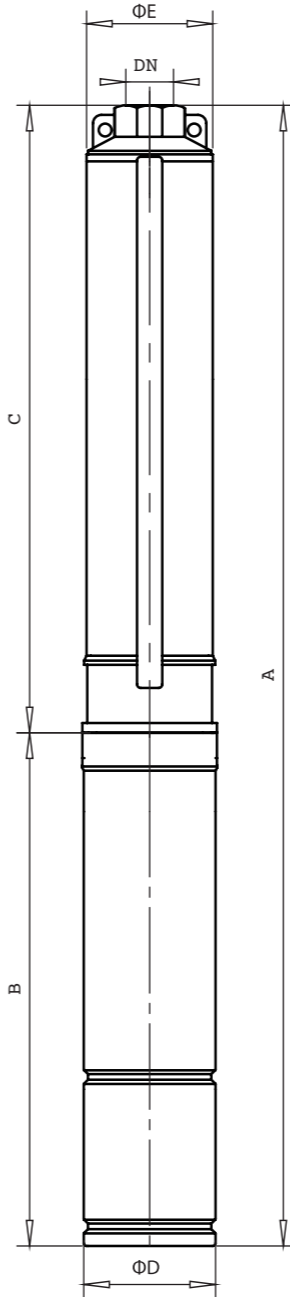

hydroo®

Model	Size (mm)						Weight (kg)	
	A	B	C	DN	ΦE	ΦD	Pump with motor	Controller
S3.5P2-13	1011	400	611	1.5"	90	88	16	0.75
S3.5P2-18	1185	435	750	1.5"	90	88	18	0.75
S3.5P2-22	1382	486	896	1.5"	90	88	24	0.75

Model	Size (mm)						Weight (kg)	
	A	B	C	DN	ΦE	ΦD	Pump with motor	Controller
S3.5P3-11	978	400	578	1.5"	90	88	15	0.75
S3.5P3-15	1179	435	744	1.5"	90	88	17.4	0.75
S3.5P3-19	1361	486	875	1.5"	90	88	19	0.75

hydroo®

Be pumping partners

HYDROO Pump Industries SL
Ctra. Girona-Banyoles, km. 10
17843 Palol de Revardit
Catalonia. Spain
Tel. +34 972 394 654
E-mail: info@hydroo.com
www.hydroo.com

202118-CTL-SJP-EN
subject to amendments

